

SECTION 17, T.5N., R.1W., S.L.B. & M.

IN SOUTH OGDEN CITY, WASHINGTON TERRACE CITY, AND RIVERDALE CITY

SCALE 1" = 400'

SEE BOOK 6, PAGE 19

SEE PAGE 68

SEE PAGE 73

SEE PAGE 15

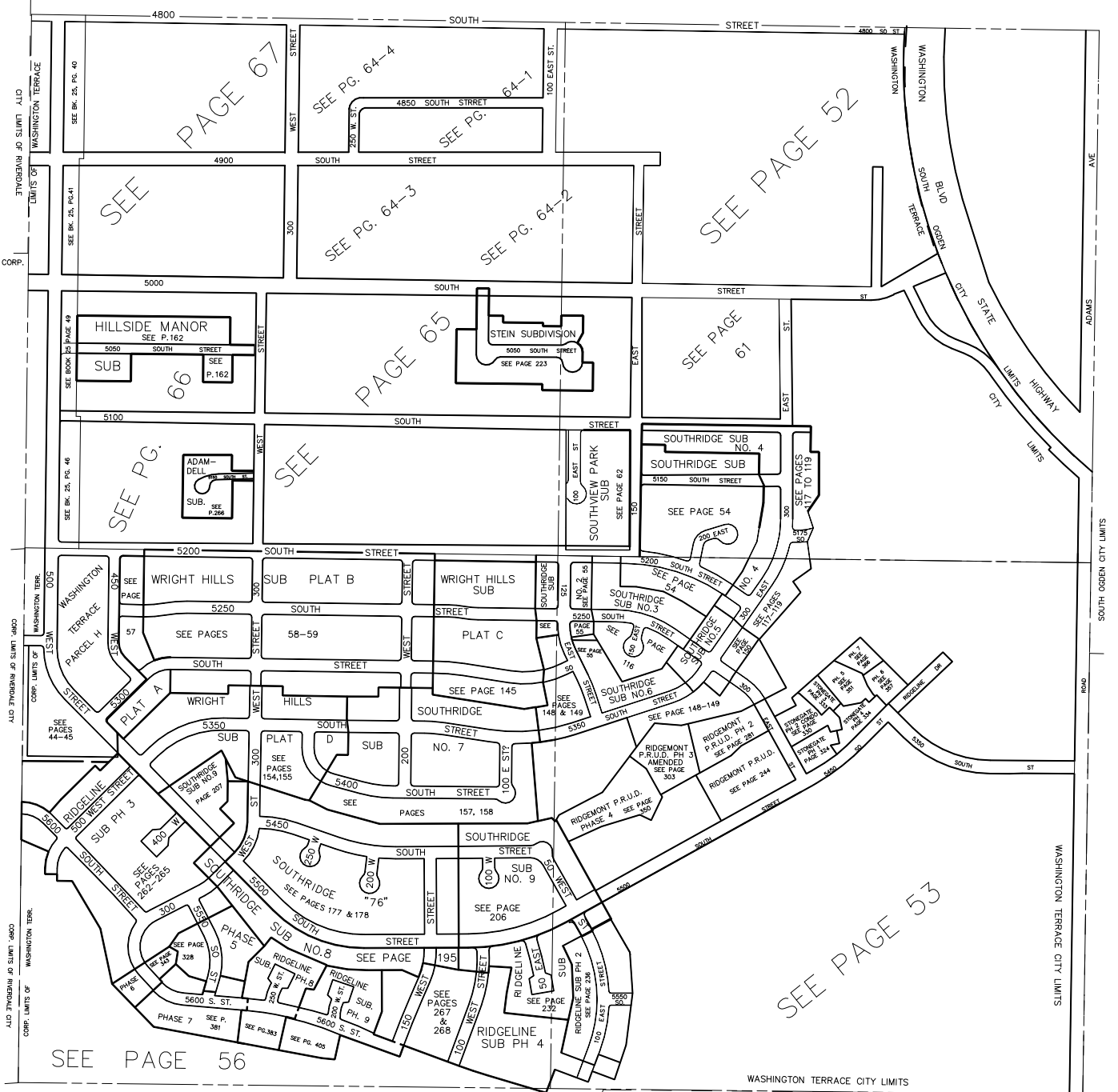

SEE PAGE 79